

INTERIOR DESIGN PORTFOLIO

ERIC SCOTT

Seminole State College 2024



Eric's set design that was nominated for a Regional Emmy



Introduction

Most of my professional life until recently has been spent backstage or behind the camera interspersed with occasional performances in front of it.

Now I am **beginning my journey as an Interior Designer**. Its a **new chapter**, but one I look forward to scripting.

My overall **design philosophy** is “**Enjoy the moment**” - to engender one's ability to fully enjoy their surroundings and be present in the moment.

My **love of design** derives from enjoying **solving problems** of flow, efficiency, and ergonomics. Furniture should be comfortable, sturdy, and stylish, but also complement its surroundings. That goes for the environments its in as well!

TABLE OF CONTENTS

Pg 4

Studio 6: Pediatric Behavioral Health Facility
"IALAC Center for Health"

Pg 7

Studio 5: Boutique Hotel
"The Worcester Social Club"

Pg 9

Studio 4: Corporate Design
"Our House"

Pg 11

Studio 3: Commercial Hospitality Design
"Cosmic Conscious Cafe and Art Gallery"

Pg 13

Studio 3: Commercial Hospitality Design
"Timeless Cafe & Welcome Center"

Pg 16

Furniture Design
"Infini"

Pg 18

Luminaire Design
"Metallum et Lignum"

Pg 19

Public Works Design
"Kenzo Tange Memorial"

Pg 20

Visual Communications
"Hand Renderings"

Pg 21

Construction Documents
"Example from Con Docs class"

All renderings and virtual models created using Revit, Enscape, and Lumion

"IALAC Center for Health"

Studio 6 Project - Capstone project basing the design solutions on evidence-based research, students were tasked to create a healthcare-focused facility for a Pediatric Behavioral Health Center.

FLOORPLAN

- The space plan is designed to balance the entirety of the clinic as a whole via the general layout along the cardinal directions in a way that isn't strict but is faithful to the organic aspect of nature in the concept image.



- "Barricade Risk – The direction of the swing is very important." – all doors in therapy areas and between common and therapy zones have out-swing action and anti-ligature hardware. "Doors that are hinged to swing out of the room are more difficult to barricade..." (McMurray, 2022). Design Feature 1

CONCEPT



AI generated image

Love.

To paraphrase the movie "Moulin Rouge", "Love is a many splendored thing..." Love is exactly what the IALAC Center for Health is built and founded on. Inspired by the work of multi-award winning poet Nikki Giovanni's work, "I Am Loved" with illustrations by Ashley Bryan combined with the work of Dr Sidney B Simon, a pioneer in values clarification education whose IALAC exercise became famous and is where the center gets its name from, the IALAC Center for Health focuses on ensuring that all who come through the doors of the clinic know they are loved, loveable, and capable as they are assisted in their development.

Located in New London, Connecticut, the IALAC Center is perfectly positioned near some of the best mental health facilities in the country (McLean Hospital and Massachusetts General Hospital in Massachusetts and Johns Hopkins Children's Center and Sheppard Pratt Hospital in Maryland) to partner with the continuation of care opportunities. The Center's use of curvilinear lines, bright colors, and clearly defined age zones allow for ease of use and wayfinding within the facility. Rainbows for color palettes harken back to the book "I Am Loved" while accents of calming palettes of greens and blues are used for quiet spaces to de-stress, de-escalate, and find respite from sensory overload or overstimulation. In total, this design approach is intended to provide safety, security, fun, and as stress-free a space as possible for the patients, families, and staff as it focuses on LGBTQIA+ youth and their families.

"IALAC Center for Health"



Public corridor with poem detail and wayfinding Acoustic Mobiles by LightArt



Reception Area and Check-in desk



Research Consult rm 13-18 yr zone



Large Group Therapy rm 5-12yr zone

"IALAC Center for Health"



Caregiver breakroom



Public corridor with detail explaining IALAC concept and its history



Caregiver respite rm



Exterior of clinic

"The Worcester Social Club"

Studio 5 Project - Design a lobby with overlook, court- yard, and bar/cafe

Inspiration - Industrial Revolution, Art Nouveau, Arts & Crafts, Modernism

Theme - warm, inviting, and inclusive space converted from a former factory

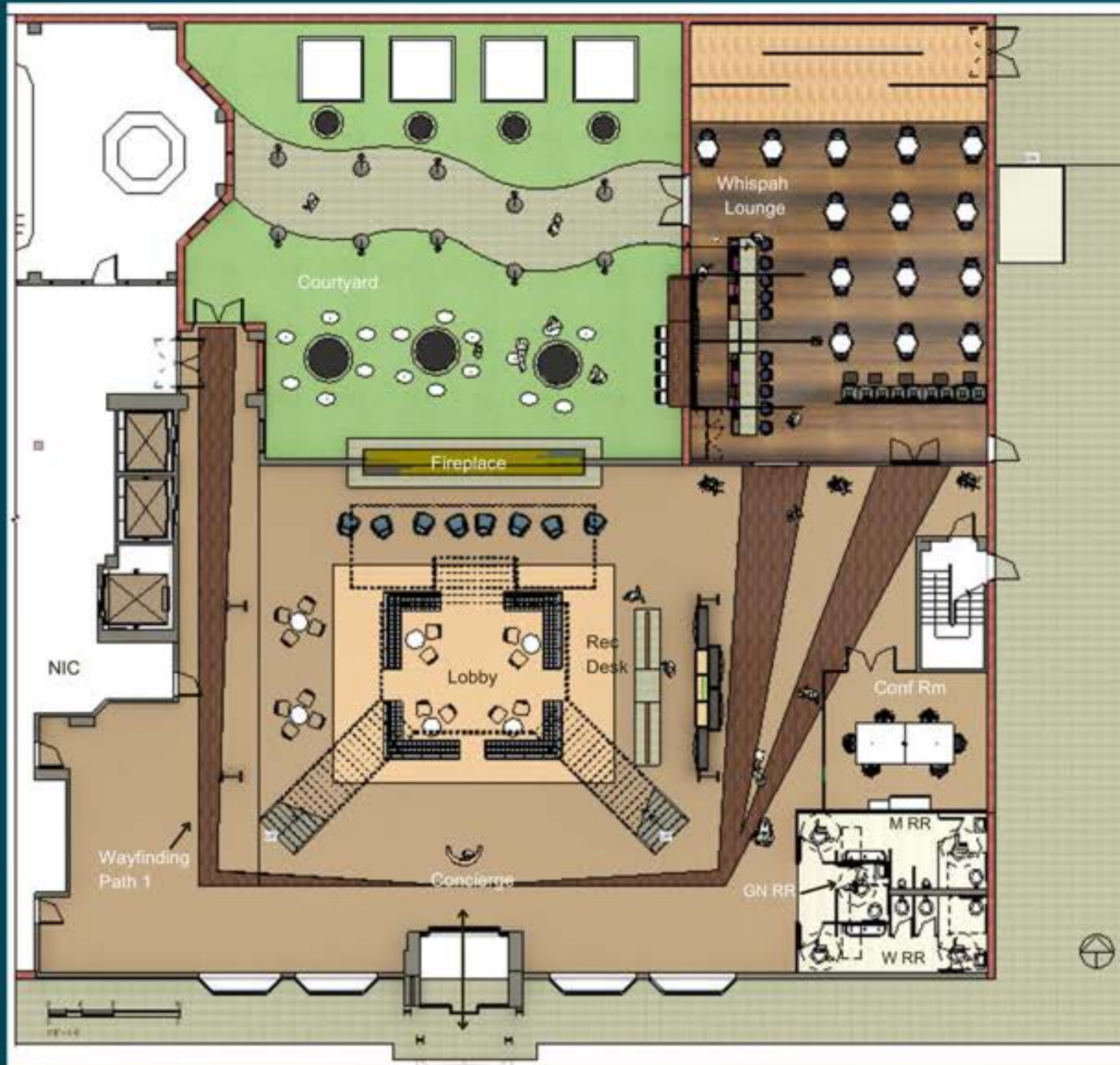

Level 1 Floorplan

scale: 1/8" = 1 - 0"



Concept Image - a section of the Union Terminal Mosaic Murals in Cincinnati, OH



Hotel Logo

"The Worcester Social Club"



Grand Staircase from 2nd floor overlook



The Whispah Bar & Jazz Lounge



Courtyard



Reception Desk/Retail Area

Corporate Office Design - "Our House"

Studio 4 Project - Design a Corporate Office environment with shared spaces and work areas

Inspiration - creative freedom, industrial chic, and entertainment industry & its needs

Theme - creatives industry rental and production facility with shared spaces, editing bays, multi-function recording studio, and collaborative areas



Level 1 Floorplan



collab area and private conf room



Giant's Causeway inspired staircase



Reception Desk & Waiting Area



Break Nook

"Our House" continued



Parent's Room/Quiet Room



Private Office



Cafe area



Collab Area



Terrace

"Cosmic Conscious Cafe & Art Gallery"

Studio 3 Project 1 : Design a coffe house/art gallery combo that is a performance venue at night

Inspiration: The Beatniks, Lawrence Ferlinghetti, Slam Poetry, and Jazz

Theme - An homage to the experience of light & sound, the spoken and sung word, and the musicality of life

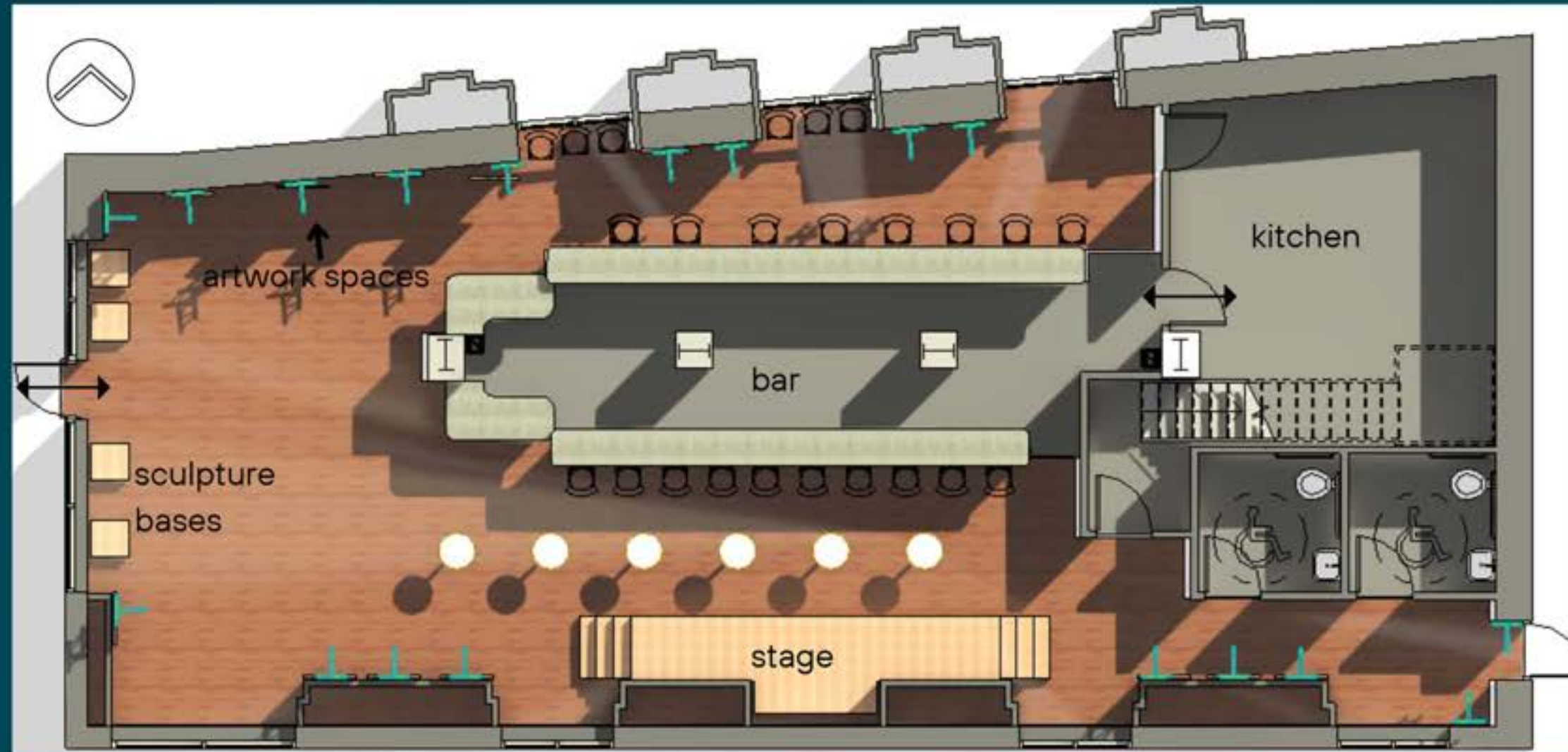

Level 1 Floorplan

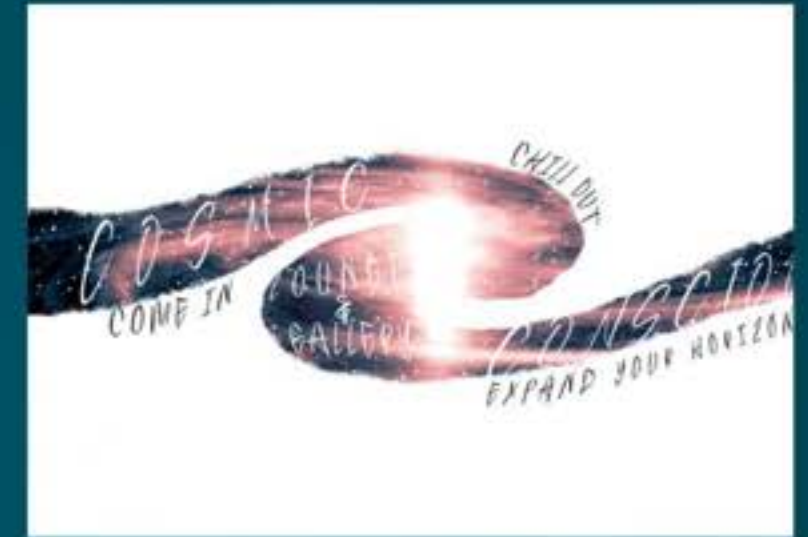

Logo created in procreate

"Cosmic Conscious Lounge & Gallery"



Bar rendering including truss rig



Front entry sculpture bases and art hangings

"Timeless Cafe & Welcome Center"

Studio 3 Project 2: Design welcome center & cafe in Zurich, Switzerland International Airport. Include an info kiosk

Inspiration: Watches and clocks

Theme: What would it be like to step inside a watch

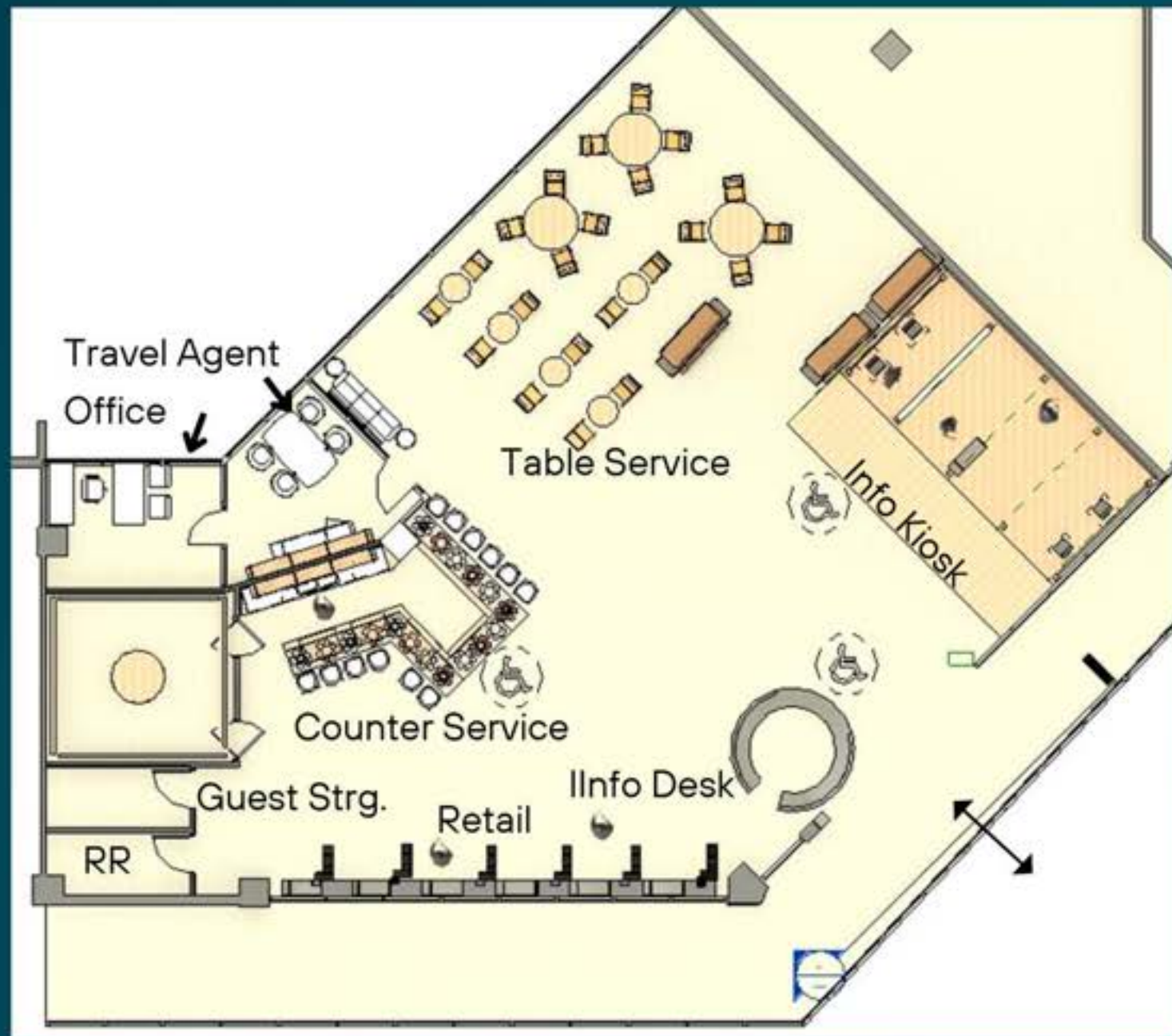

Level 1 Floorplan

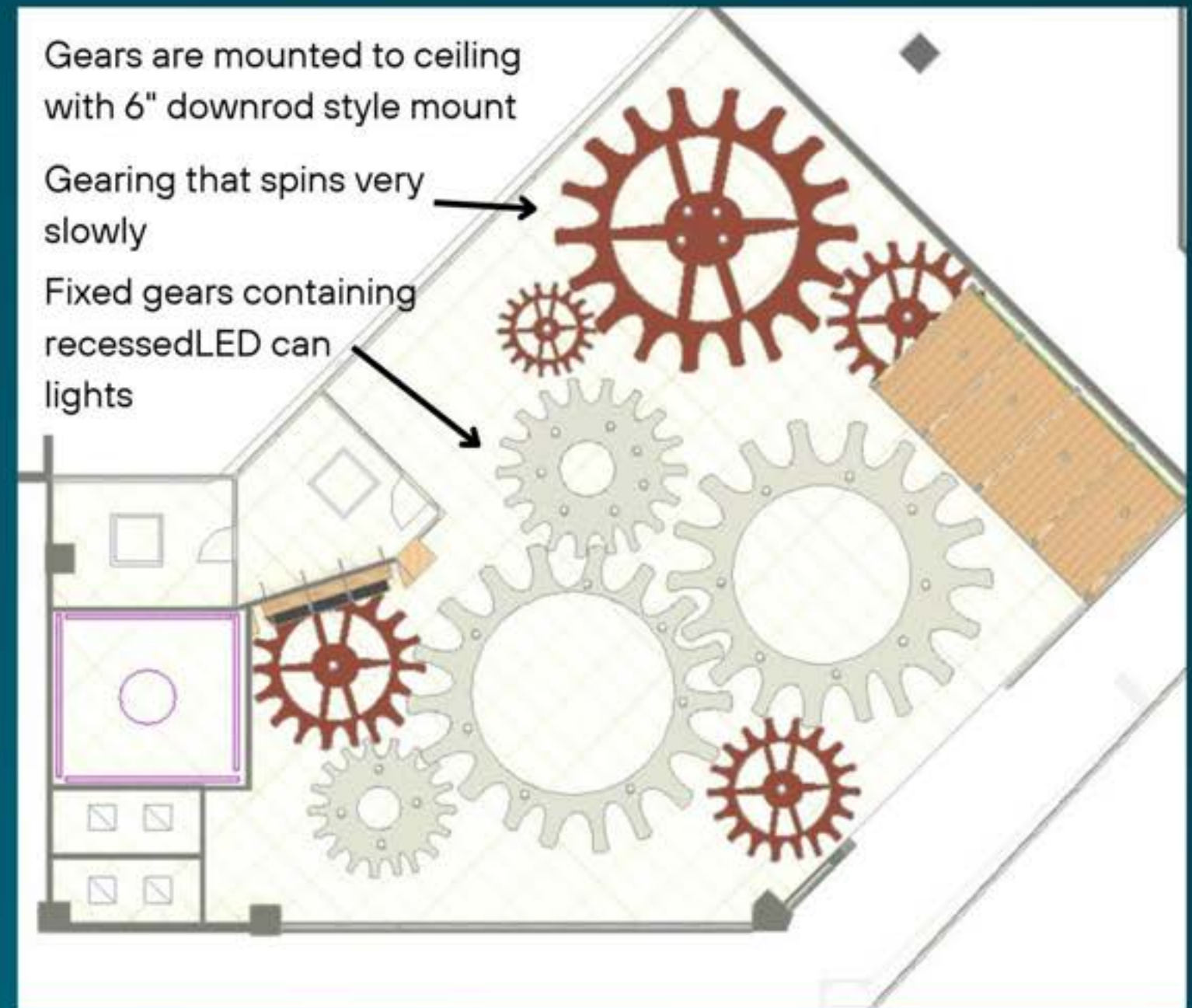

Level 1 RCP

"Timeless Cafe & Welcome Center" continued



Info Kiosk - touch screen monitors & computers to assist travelers with arrangements and more
designed to resemble timber framing earth houses of Northern Europe



Counter service at the cafe - designed to look like watch springs

"Timeless Cafe & Welcome Center" continued



Table seating area - chairs resemble watch buckles and bases resemble watch springs



Table inlay detail in seating area - hands of the watch faces point in direction of tourist attractions in Switzerland as related to Zurich's location

Furniture Design - "Infini"

Project - Design a kitchen island and chairs that could become a product line or collection

Inspiration - Art Nouveau lines and curves

Theme - Invoke infinity through the use of wood and metal

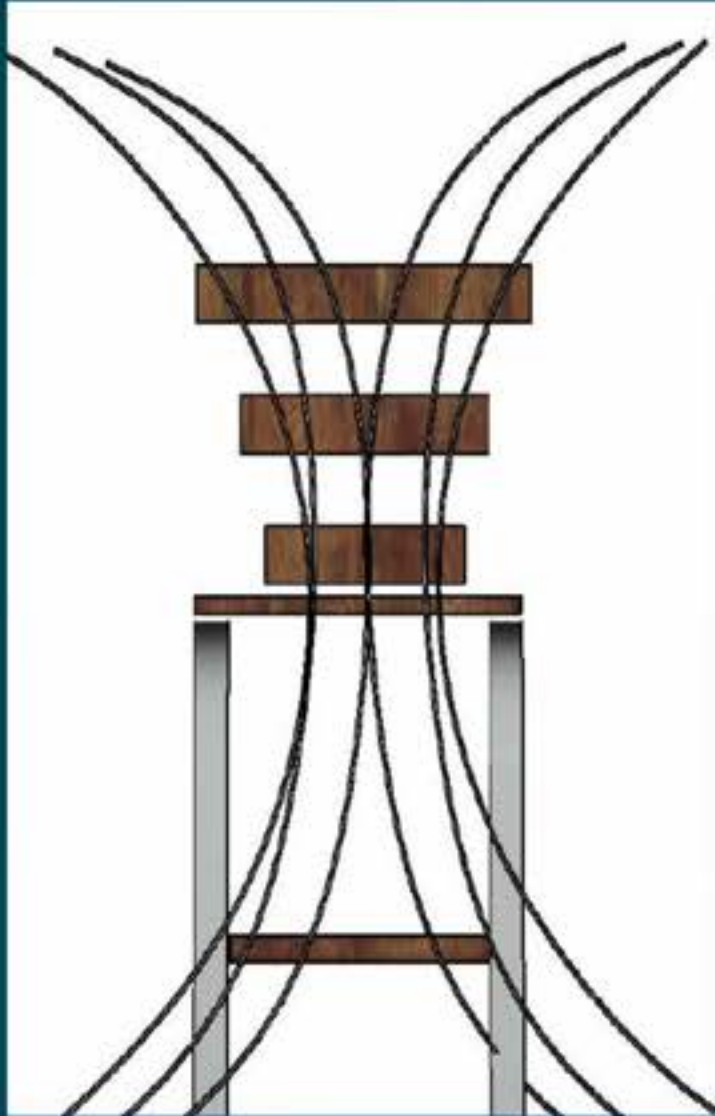

Close-Up of Back of Chair

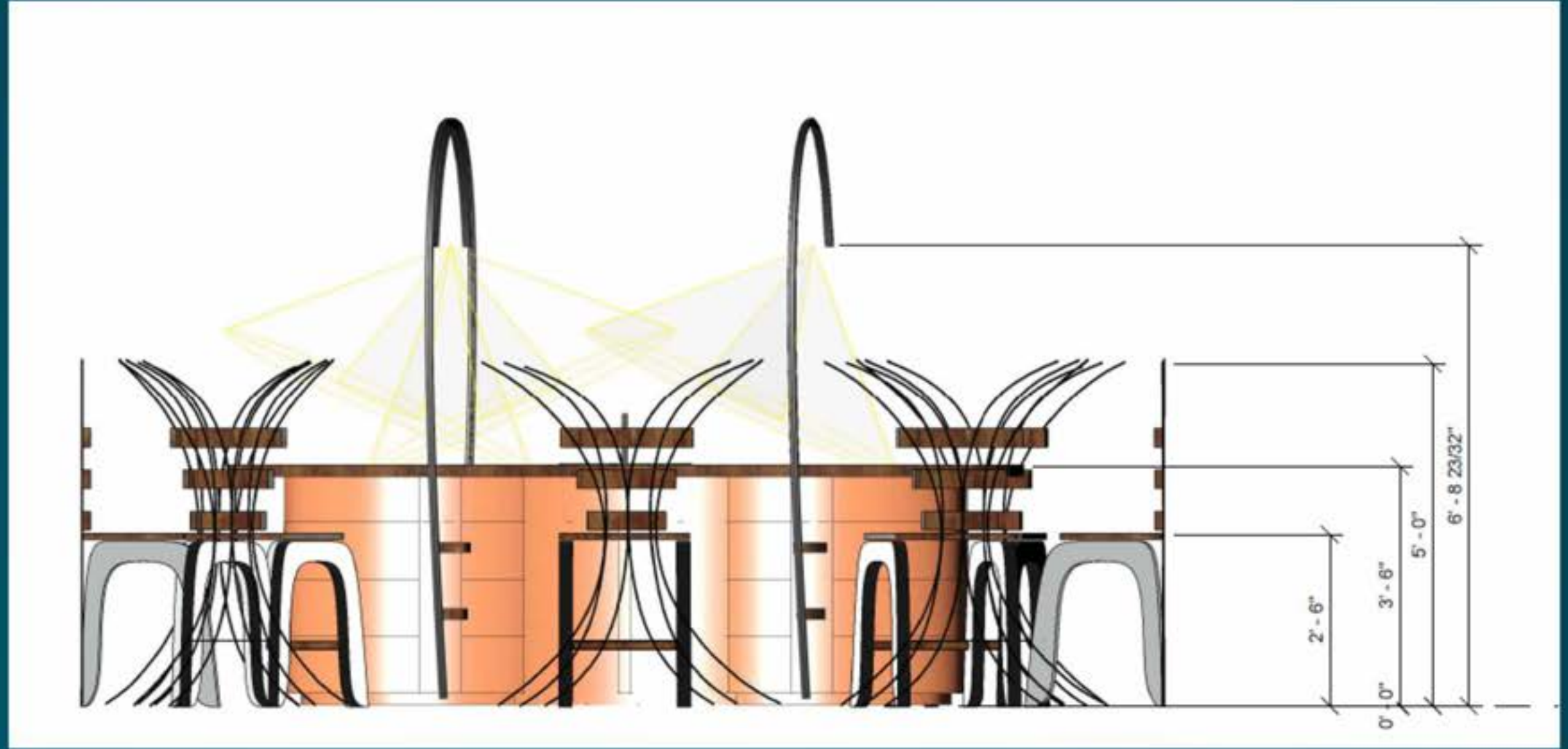

Long View showing Light Path and Dims

"Infini" continued

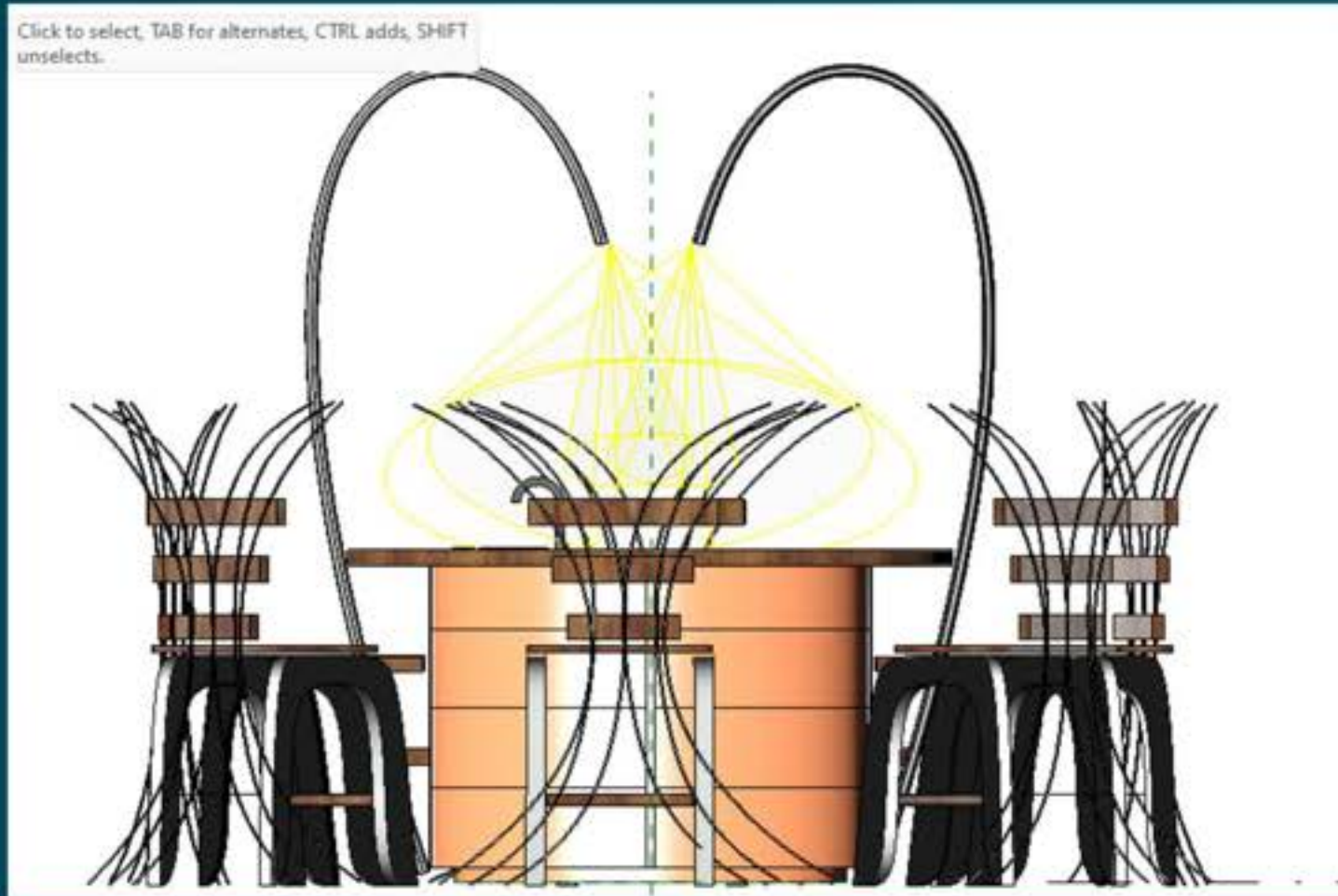

Short View showing Light Path



Scale model of Infini - not a rendering

Luminaire Design - Metallum et Lignum

Project - design a Luminaire

Inspiration - the Blacksmith's Basket Twist technique

Theme - exploded basket twist leaving in- creasing in size from one unit through to the 3rd unit. Sizing is 1 ft difference.



Finished model in 1:1 scale - not a rendering

Left = 2ft long Right = 1ft long

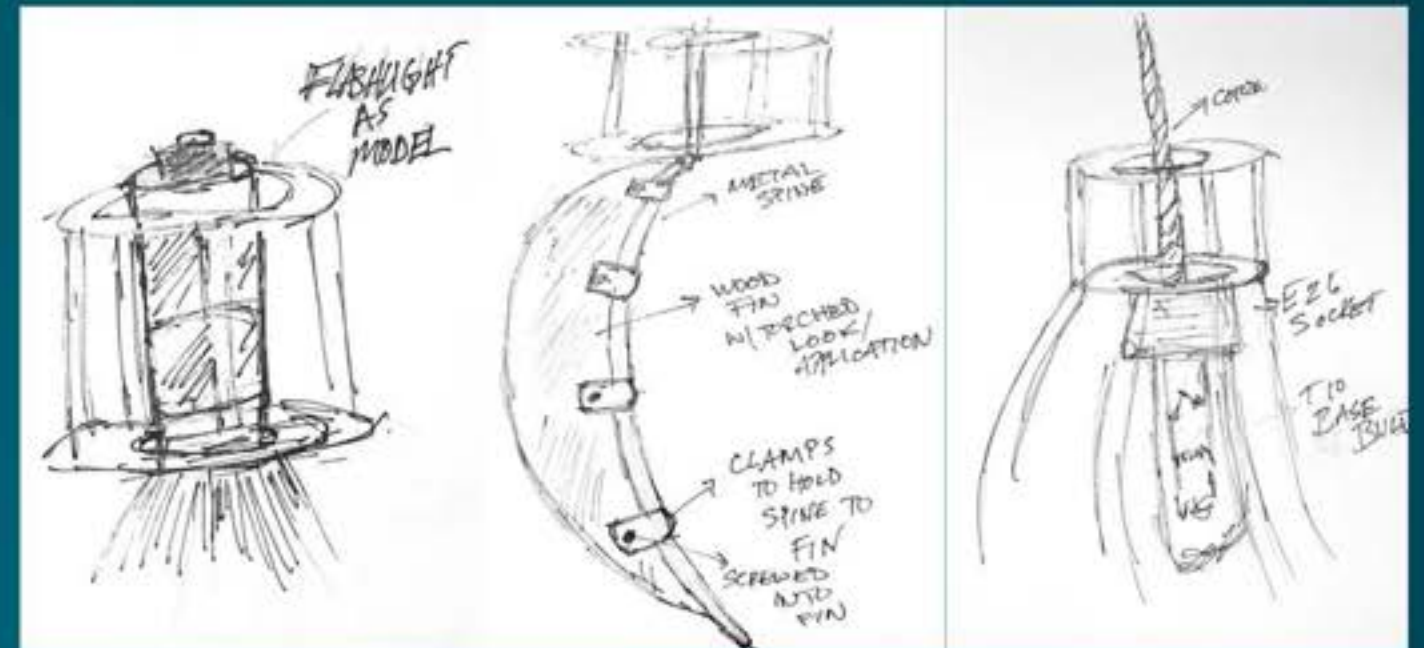
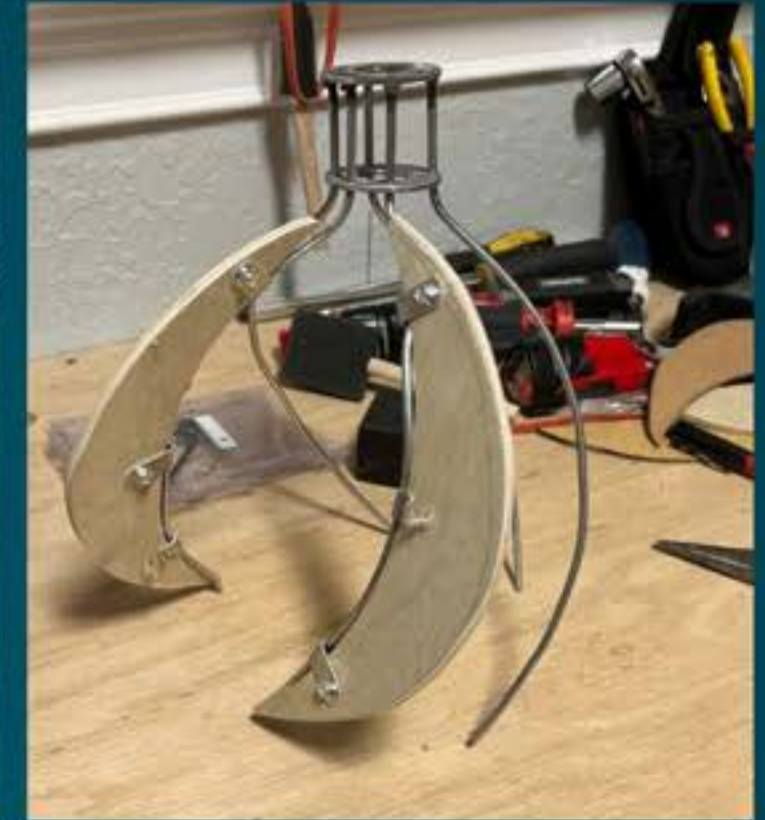

Kenzo Tange Memorial

Project - Design memorial to architect Kenzo Tange

Inspiration - Japanese architecture and shrines

Theme - Tange's unrealized Plan for Tokyo Bay



Scale model - not a rendering



Visual Communications - Hand Renderings



From Construction Docs class

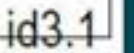
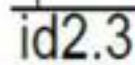

INTERIOR DESIGN PORTFOLIO

ERIC SCOTT

Seminole State College 2024

ericscott@live.seminolestate.edu

www.linkedin.com/in/egscott7elementsdesign